

CLAIRE LILIENTHAL

K-8 SCHOOL

SAN FRANCISCO UNIFIED SCHOOL DISTRICT

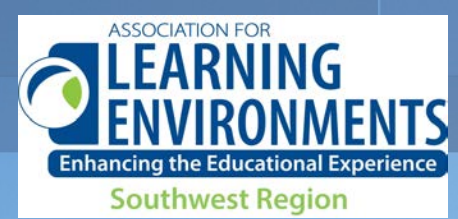

San Francisco, CA | K-8 School
Gym & Classroom Building Addition
Lionakis

NEIGHBORHOOD CONTEXT

Located blocks away from both the San Francisco Bay and the Palace of Fine Arts, the community had concerns about the new development. While stakeholders were extremely supportive of removing the existing portables, their concerns about a contextually-sensitive design needed to be addressed. On the street side—the public face—the new building embraces elements of the existing campus architecture to create a modern complement which blends with the surrounding neighborhood.





BRINGING THE OUTSIDE IN

With the addition, a new courtyard was created, providing ample opportunity to enhance indoor-outdoor connections with roll-up garage doors in the fitness studio and wet lab, expanding the learning environment while taking advantage of the temperate Bay Area climate. On the courtyard side—the campus face—a playful façade infuses the campus with colors reminiscent of the ocean that is just a few blocks away.



OPEN SPACES

The design concept—“Wave of Learning”—brings the marina environment indoors with a palette of blues and yellows. The curve of ocean waves is captured in the flooring, and in the soft and flexible furnishings which make the wide hallways and stairwells, classrooms and labs natural spaces for gathering, collaborating and studying.



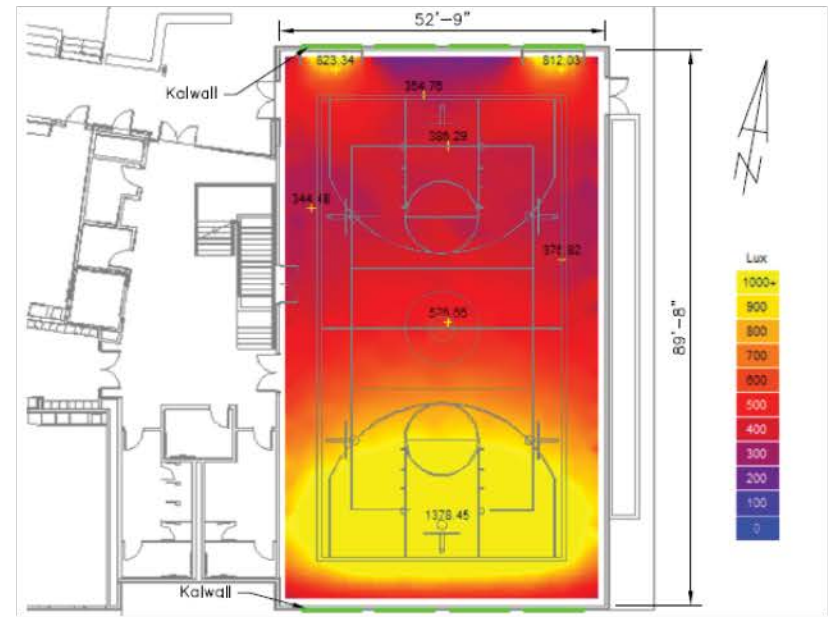

PHOTOMETRIC STUDY

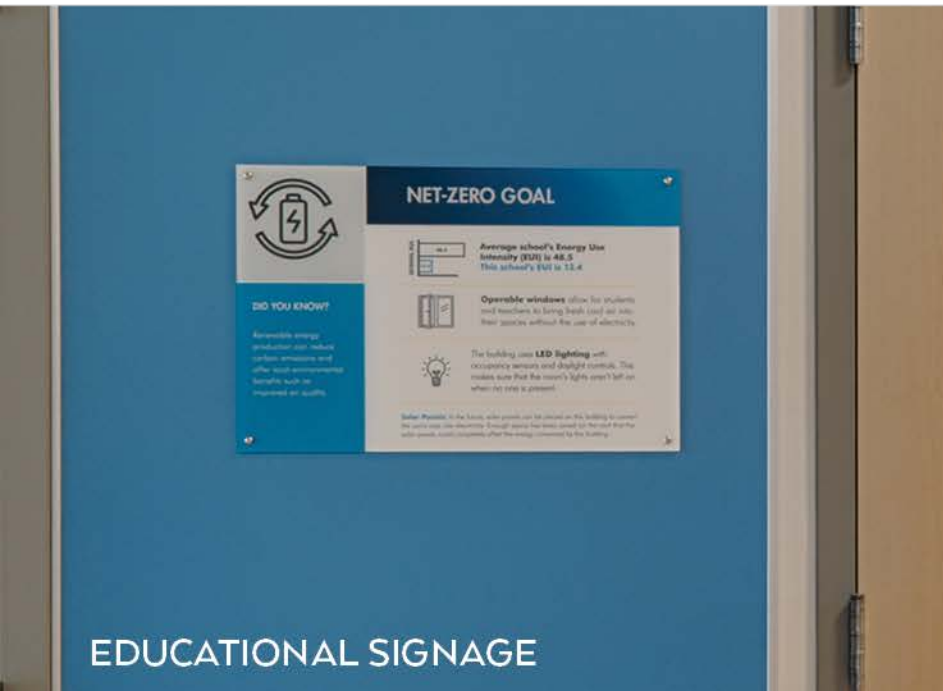

EDUCATIONAL SIGNAGE

SUSTAINABILITY

The Claire Lilienthal K-8 School Addition is the District's first Zero Net Energy Ready project and has set the standard for future District projects. The new gymnasium is naturally daylit and solar-ready after daylighting studies were completed during design. Learning environments feature daylighting and operable windows, and sustainable signage educates students, faculty and community members on the sustainable design features of their new building.

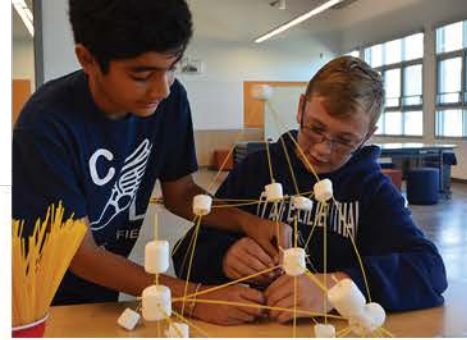

DID YOU KNOW?

To ensure that the interior learning environment matches the vision for the addition, the District also selected the design team to manage the furniture package, from selection and specification to bidding and procurement.

INNOVATION LAB

Claire Lilienthal K-8 School's vision is to create integrated learning opportunities for their students. The new Innovation Lab functions as maker space and technology hub, promoting hands-on learning, exploration and collaboration.





FURNITURE PLAN

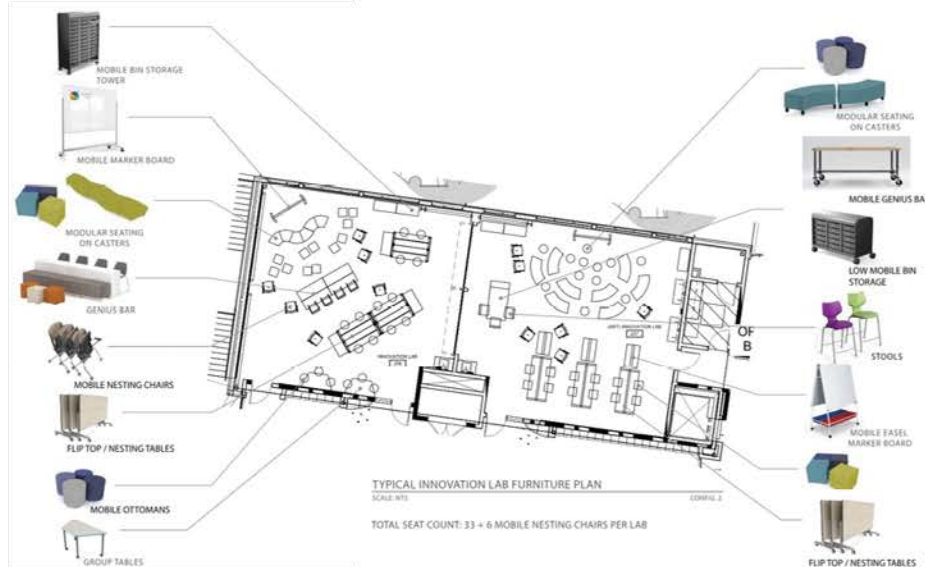

NextGEN FURNITURE

Soft, flexible and movable furnishings foster nextGEN learning and empower students and faculty to configure learning environments to best support varied learning styles, project-based learning and small-group work. Coupled with a technology-rich backbone, capturing the “spaces in between” extends the learning environment beyond the four walls of the classroom.



COURTYARD ACCESS

Leveraging a portable replacement into a more dense, two-story classroom building reclaimed space on this tight site for outdoor learning, middle school athletics and elementary play. An outdoor science lab connects to the science lab with a roll-up garage door, while a Learning Courtyard creates a shared connection between the original building and the new and completes the revitalized Claire Lilienthal K-8 School.



- 1 Single Point of Entry
- 2 Learning Courtyard
- 3 Play Yard
- 4 Outdoor Science Lab

SITE PLAN

At San Francisco Unified School District's Claire Lilienthal K-8 School, the desire to replace existing portables, while adding specialty labs and physical education spaces, served as the impetus for the addition of a new two-story classroom building and gymnasium. With a tight, 1.44 acre site, space was at a premium and the addition needed to not only meet the program needs, but also complement the design aesthetic of the Marina neighborhood.



FLOOR PLANS

SUPPORTING A NEW EDUCATION IDEAL

1ST FLOOR

- 1 Science Lab
- 2 Fitness Studio
- 3 Student Breakout Space
- 4 Classrooms

2ND FLOOR

- 5 Innovation Labs
- 6 Gym
- 7 Student Breakout Space
- 8 Student Breakout Space
- 9 Classrooms

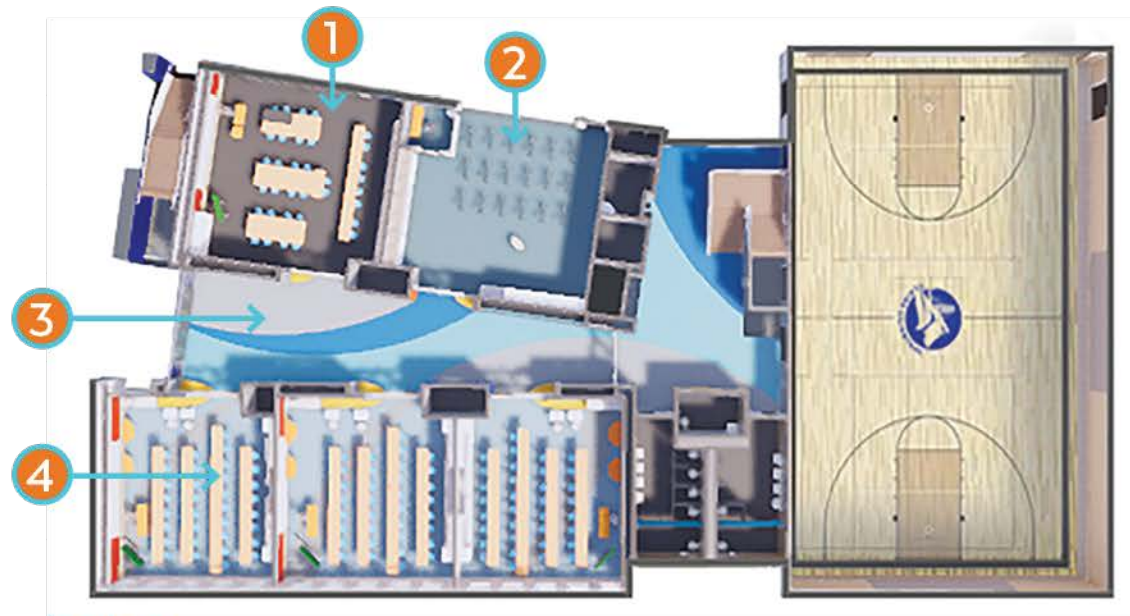

1ST FLOOR

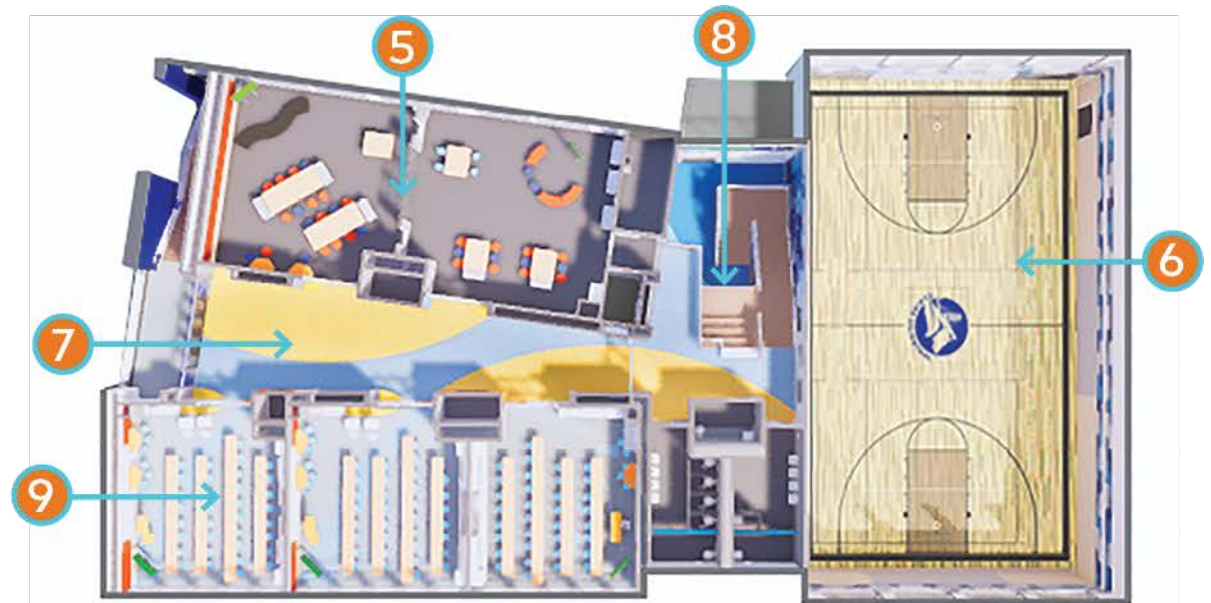

2ND FLOOR

Project Narrative (page 1)

Minimum Space, Maximum Impact

Every school revitalization project presents a laundry list of design challenges, but in San Francisco's urban environment, revitalizing an existing campus presents an even more challenging set of constraints: compact sites, established neighborhoods with deep roots and design aesthetics, construction staging and interim housing...just to name a few. San Francisco Unified School District's Claire Lilienthal K-8 School was no exception. With a desire to replace existing portable classrooms with a new, permanent two-story classroom building and add a new gymnasium to accommodate middle school programs which were previously housed on a different campus, the team set out to design a solution which would address these programmatic needs within the 1.44 acre site, while maintaining the Marina neighborhood's design aesthetic.

Planning Process

A robust planning process included both site-level committee meetings with faculty and staff, as well as Town Hall-style meetings with community members. Community stakeholders were extremely supportive of the removal of the existing portables to better complement the existing historic classroom building and neighborhood context but had concerns about the proposed two-story replacement building. Many homes adjacent to the school boast views of the Palace of Fine Arts, so maintaining their views and developing a contextually-sensitive design were key design drivers. As a magnet school whose vision is to create integrated learning opportunities, faculty and staff envisioned flexible, technology-rich classrooms and labs to foster collaboration and hands-on learning.

Learning Environment & Design

The primary goal was to leverage the portable replacement into new, innovative spaces that were simply impossible to integrate into the existing historical building. Today, a fitness studio (adjacent to the new gym) supports the physical education program and a flexible wet lab supports the arts and sciences. An Innovation Lab functions as both maker space and technology hub, promoting hands-on learning, exploration and collaboration. The design team also created the furniture package for the project, ensuring that the furnishings, fixtures and equipment would support and enhance the nextGEN learning environment that stakeholders envisioned for Claire Lilienthal K-8 School.

With the addition, a new courtyard was created, providing ample opportunity to enhance indoor-outdoor connections with roll-up garage doors in the fitness studio and wet lab, expanding the learning environment while taking advantage of the temperate Bay Area climate. On the courtyard side—the campus face—a playful façade infuses the campus with colors reminiscent of the ocean that is just a few blocks away. Inside, design inspiration around the “Wave of Learning” draws upon the marina environment indoors with a palette of blues and yellows. The curve of ocean waves is captured in the flooring, and in the soft and flexible furnishings which make the wide hallways and stairwells, classrooms and labs natural spaces for gathering, collaborating and studying.

Project Narrative (page 2)

Community Environment

It was important to the community's stakeholders that the new building respect the neighborhood and integrate into the existing community fabric. On the street side—the public face—the new building embraces elements from the existing architecture to create a modern complement to the original building, while the new gymnasium was sited and designed to enhance the surrounding community through after-hours and weekend access.

Physical Environment

The new classroom wing flares off the new gymnasium and maintains the interior corridor focus and single-building security that the campus was used to. Located adjacent to the existing two-story building, which houses administration, the new building

High Performance

In San Francisco, stakeholders expect sustainable design as the standard. As a prototype for future District projects and the District's first Zero Net Energy Ready project, this strategic addition sets the new standard for future growth, development and campus revitalization. The new gymnasium is naturally daylit and solar-ready, while the learning environments feature daylighting and operable windows for natural ventilation, taking full advantage of the location adjacent to the San Francisco Bay. Throughout the addition, sustainable signage educates students, faculty and community members alike on the sustainable features in their new building, from low-E insulated glazing on the windows, to all-electric equipment, bio-retention areas, rain water harvesting and sustainable materials throughout.

Completed in time for the 2019-2020 school year, the Claire Lilienthal K-8 School Addition brings together the student body on an inclusive, nextGEN K-8 campus, making maximum impact within the constraints of minimal space and San Francisco's urban environment.

Project Budget

The budget for this project was \$15,711,459.

PROJECT DETAILS

1. Project Name	Claire Lilienthal K-8 School Addition
2. District Name	San Francisco Unified School District
3. City/State	San Francisco, CA
4. Superintendent	Dr. Vincent Matthews
5. Occupancy Date	August 2019
6. Grades Housed	K-8
7. Design Capacity (# of students)	270 students
8. Site Size (acres)	1.44 acres
9. Gross Area (Sq. Ft.)	21,995 square feet
10. Space per Pupil (Gross)	81.46 square feet per pupil
Design Build (Y/N)?	No
If yes, Total Costs	
If yes, Cost Include:	
If no, Site Development Costs	Breakdown not available
If no, Construction Costs	Breakdown not available
If no, FF&E	FF&E was not included in the total cost
If no, Other:	
If no, Total Cost	\$15,711,459

Please include a PDF of the educational specifications/program of requirements along with your submittal package.

**ED SPECS / PROGRAM OF
REQUIREMENTS**



PROJECT DATA: (CONFIDENTIAL INFORMATION)

Submitting Firm: Lionakis	
Project Role	Architect of Record
Project Contact	Laura Knauss
Title	Principal
Address	1919 Nineteenth Street
City, State or Province, Country	Sacramento, CA 95811
Phone	(916) 558-1900

Joint Partner Firm: N/A	
Project Role	
Project Contact	
Title	
Address	
City, State or Province, Country	
Phone	

Other Firm: N/A	
Project Role	
Project Contact	
Title	
Address	
City, State or Province, Country	
Phone	

Construction Firm:	
Zolman Construction & Development	
Project Role	General Contractor
Project Contact	Quien Magsombol
Title	Project Manager
Address	565 Bragato Rd , Ste B
City, State or Province, Country	San Carlos, CA 94070
Phone	(650) 802-9901

Print, Sign, Scan and Submit with Package

Name of Project: Claire Lilienthal K-8 School Addition

Location of Project: San Francisco, CA

A4LE has our permission to:

- ✓ Send photos electronically to jury members (required for entry).
- ✓ Display photos in the award winners' area of the website, if selected as a finalist.
- ✓ Display photos on other sections of the website as representative A4LE projects.
- ✓ Print photos in A4LE newsletters.
- ✓ Print photos on A4LE marketing materials, i.e. brochures , awards, call for entries, etc.
- ✓ Print photos and project details in the A4LE Design Portfolio, if selected as a finalist.
- ✓ Special projects with prior permission.

Please Note: A4LE maintains an in-house archive of school designs as part of our research library.

Your information will be entered and recorded as one of those designs.

Firm: Lionakis

Responsible Party/Photographer: Tim Maloney, Technical Imagery Photography

Signature: _____

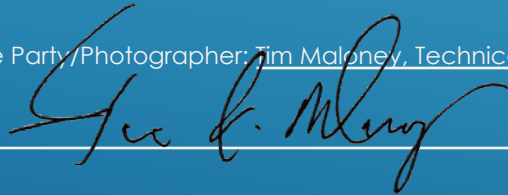

Date of Release: April 2, 2020

**PHOTO RELEASE: (RETURN SIGNED
COPY WITH YOUR SUBMITTAL)**